

KENTUCKY BINET FOR HEALTH AND FAMILY SERVICES
 DEPARTMENT FOR PUBLIC HEALTH
 ONSITE SEWAGE DISPOSAL SYSTEMS
 SITE EVALUATION

181960

090
 County

1-350-17
 Application No.

Owner's Name Danny Raiser

Lot Address Lot 38 Valley View

Applicant's Name Danny Raiser

Address 290 Wire Ln Marks Ln

Evaluation Factors	Proposed System Area	Alternative Area 1
1. Topography (slope %)	6% S PS U	S PS U
2. Landscape Position	side S PS U	S PS U
3. Soil Texture and Group	0-20" SIC III 20-29" SIC IV 29+ C II S PS U	S PS U
4. Soil Structure	0-29" blk 29-42" mass S PS U	S PS U
5. Internal Soil Drainage	None to 30" S PS U	S PS U
6. Soil Depth (in.)	42" S PS U	S PS U
7. Restrictive Horizons (in.)	mass @ 29" S PS U	S PS U
8. Available Space	2.72 acres S PS U	S PS U
9. Overall Site Classification	S PS U	S PS U
10. Soil Series (if available)		

S = SUITABLE PS = PROVISIONALLY SUITABLE U = UNSUITABLE

11. List site and/or system modifications or alternatives required for site approval and the specific area selected for system installation:

- Met Danny Raiser & Jackie Fogle (Installer)
- House & Driveway needs to be ~~top~~ laid out
- Plateau in front before drops off would be 11" system.

FILLED OR DISTURBED SITES ONLY

12. Percolation Test Required: Yes No

13. Percolation tester instructions: Test to be run in flagged area at depth of _____ in. Presoaking of test holes to be in accordance with Section 6. (4) () Test measurements to be conducted in accordance with Section 6. (5) ()

Attach copy of application and site plan. Draw in evaluation areas and designate area selected for system installation (flagged area).

12-5-16 Start _____ A.M.
 Date Requested Time _____ P.M.
12-5-16 End _____ A.M.
 Date Completed Time _____ P.M.

Holly Mels 1068
 Certified Inspector Cert. No.
Nelson
 County or District Health Department



1 O S E Y R

2 O S P Y R

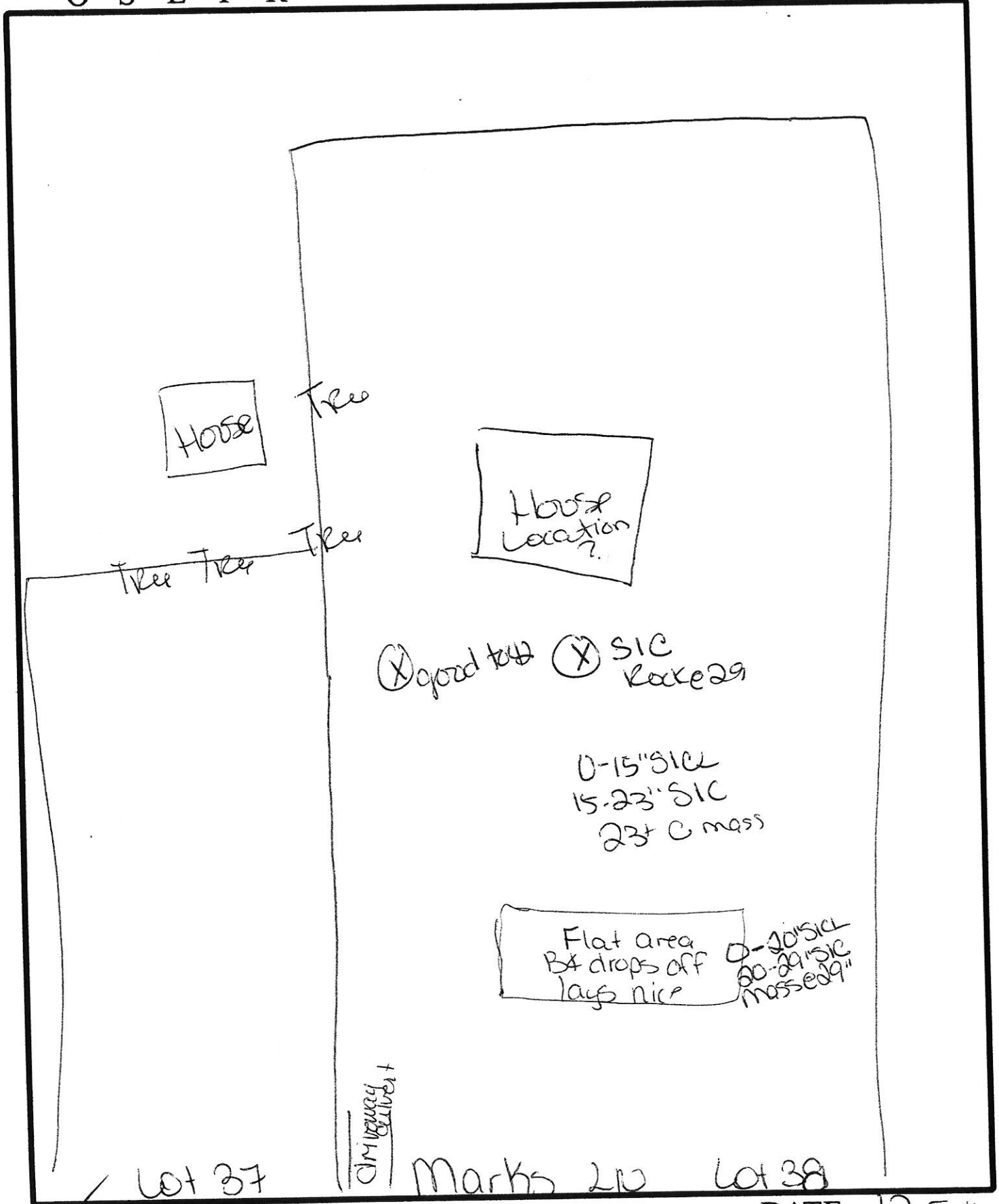

SITE PLAN
 PROPOSED SYSTEM
 INSTALLED SYSTEM

DATE 12-5-16
 CI 1068